

MITSUBISHI FUSO FK / FM HEATED MIRROR INSTALLATION MODEL YEARS: 2005 AND UP

NOTE: RAISE WINDOWS TO UPPERMOST POSITION. DISCONNECT NEGATIVE BATTERY LEADS PRIOR TO ALL OPERATIONS; RECONNECT ONLY WHEN INDICATED BELOW.

| <i>KIT KT651002 PARTS LIST</i> | | |
|---------------------------------------|----------------------|------------|
| Part Number | Description | QTY |
| FP100039 | 7" Wire Tire | 25 |
| FP100112 | 1/4 X 3/8 GROMMET | 4 |
| FP100113 | 3/8 X 1/2 GROMMET | 2 |
| FP100114 | 14-16 G CONNECTOR | 4 |
| FP100115 | 1/4 X 1/2 BUSHING | 2 |
| FP100158 | S/S HEATED MIRROR | 2 |
| MBO31945 | TAPE, ELECTRICAL | 2 |
| MK386086 | HEATED MIRROR SWITCH | 1 |
| MK387280 | RELAY | 1 |
| MS810965 | FUSE, BLADE (10A) | 1 |

DRIVER SIDE

A. DOOR TRIM PANEL REMOVAL *(save all parts for reuse)*

REMOVE:

1. Plastic trim cover at rear of window arm rest.
2. Power window/lock switch panel. Disconnect harness.
3. Window arm rest mounting bolts (12mm head).
4. Window arm rest.
5. Phillips screw at trim panel front edge.
6. Phillips screw in door release handle pocket.
7. Door release handle pocket.
8. Door trim panel by carefully pulling perimeter clips then lifting at weatherstrip edge.
9. Waterproof film. Set aside with adhesive side up.

B. MIRROR STAY REMOVAL AND DISASSEMBLY

REMOVE:

1. Mirror stay pivot bolt caps (no tool required) and bolts (17mm head) at lower and upper mounting brackets. Set hardware aside (caps, bolts, nuts, and lockwashers).
2. Mirror and stay assembly from door and place on a non-marring work surface. Set washer clips aside.
3. Two Phillips-head bolts at lower mounting bracket.
4. Lower mounting bracket. Identify gasket and orientation at lower bracket, then remove.

5. Upper and lower stem nuts (1/2" size) and washers from original mirror head. Loosen bolt (12mm head) at lower mirror head clamp bracket and slide bracket down to clear lower stem bolt.
6. Original mirror head from mirror stay and set aside.
7. Upper and lower stem nuts (1/2" size) from heated mirror head and set aside.

C. WIRING PREPARATION

1. Remove two window track mounting bolts (10 mm head) and release four wire harness tabs along bottom of door **figure 1**. Locate two-pin connector (secured to harness with blue identification tape) **figure 2** and pull harness through bottom rear door cutout **figure 3**.
2. Remove blue tape from harness and remove two-wire connector by cutting green and black wires flush to connector end. Strip 3/8" (10mm) of insulation from these wires.
3. Use supplied template to locate wire access hole in outer door skin at lower mounting bracket. Carefully drill 1/8" (3mm) pilot hole in outer door skin only. Enlarge hole with 3/8" (10mm) diameter bit, deburr, and install wiring grommet **figure 4**.
4. Punch 1/2" (13mm) diameter hole in bracket gasket with gasket punch (use template from previous step to locate hole).
5. Using supplied bracket offset template (hole toward rear), drill 1/8" (3mm) pilot hole through bottom of lower mounting bracket. Enlarge hole with 3/8" (10mm) diameter bit, deburr, and install additional wiring grommet **figure 5**.

D. HEATED MIRROR HEAD INSTALLATION

INSTALL:

1. Upper stem of FP100101 heated mirror head (cord at bottom) into upper clamp bracket and secure with washer and 1/2" nut.
2. Lower clamp bracket over lower mirror stem bolt; do not fully tighten at this time.
3. Convex mirror (if used) on lower mirror stem bolt (below clamp bracket) and secure with washer and 1/2" nut.
4. Drilled lower mounting bracket on mirror stay using washer clip, 17mm bolt, lockwasher and nut. Do not tighten at this time.

E. HEATED MIRROR / MIRROR STAY ASSEMBLY INSTALLATION

1. Install upper end of heated mirror / stay assembly in upper mounting bracket using washer clip, 17mm bolt, lockwasher, and nut. Do not tighten at this time.
2. Feed jacketed mirror wires through lower mounting bracket, gasket, and outer door skin. Ensure that grommets remain in place; use silicone lubricant as needed.
3. **IMPORTANT: IN ORDER TO PREVENT FOULING WITH THE WINDOW AND LIFT MECHANISM, THE JACKETED MIRROR WIRES MUST PRECISELY FOLLOW THE DESCRIBED PATH WITHOUT ADDITIONAL SLACK.**
 - a. Using inner door cutouts for access, route wires along door beam to front of door. Loosely secure to door beam outer surface (away from glass) with cable ties.

- b. Route wires over door beam then down along inside wall loosely securing to vertical door brace with cable ties; do not wrap or obstruct window race with ties.
 - c. Route wires along existing harness across bottom of door loosely securing to harness with cable ties **figure 6**.
 - d. Direct mirror wires through bottom rear door cutout.
4. Trim jacketed mirror wires leaving six-inch lead. Remove two inches of gray wire jacket, strip 3/8" of insulation from black and white mirror wires, and slide crimpless heat-shrink solder connectors over each wire.
 5. Connect black-to-black, white-to-green by meshing wires ends as shown. Carefully position butt connectors with solder ring over meshed wire ends. Heat with heat gun until tubing shrinks and solder melts thoroughly **figure 7**. Allow to completely cool before proceeding.
 6. Attach completed splices to existing harness by fully wrapping with tape **figure 8**.
 7. Loosely install bolts in lower mounting bracket of heated mirror assembly.
 8. Ensure sufficient wire slack at bracket pivot for full forward and rearward mirror travel. Secure wire to mirror stay with black cable ties (three per side). Clip excess cable tie material. Trim or file tie ends flush to remove sharp edges **figure 9**.
 9. Fully tighten and trim remaining cable ties. Return existing wire harness with attached mirror wires to original position, placing slack at bottom of door well. Re-seat harness tabs in holes and install two window track bolts. Temporarily reconnect battery and confirm smooth operation of window through entire range of travel. Disconnect negative battery leads.
 10. Tighten lower mounting bracket bolts to 3.0 lb-ft.
 11. Tighten upper and lower pivot bolt nuts to 10.0 lb-ft. Replace caps.
 12. Adjust mirrors for proper visibility and tighten clamp bracket bolt.

REPEAT STEPS A-E ABOVE FOR PASSENGER SIDE

F. FINAL WIRING / RELAY AND SWITCH INSTALLATION

1. Remove passenger side dashboard kick panel by removing four Phillips screws.
2. Locate four-pin relay connector with four wires wrapped in blue identification tape **figure 10**.
3. Install MC898945 tabbed relay at bolt location (10mm head) shown and attach relay connector **figure 11**. Replace dashboard kick panel and secure with screws.
4. Remove center console by removing four Phillips screws. Remove second-rear-most blank to reveal switch opening.
5. Locate seven-pin switch connector with four wires wrapped with blue identification tape **figure 12**. Note: this connector may be obscured by vinyl floor liner.
6. Remove tape and route switch connector through switch opening in console **figure 13**.
7. Connect MK386086 switch. Replace center console and secure with screws.
8. Secure switch in switch opening with orientation as shown ("on" position toward driver side) **figure 14**.
9. Open glove box, remove tray and install two MS810965 10-amp fuses in the B23 (load) and M07 (relay) fuse locations. Replace tray and close glove box lid.

10. Reconnect negative battery leads and confirm switch and mirror operation: Turn engine start key to "ON" position, depress "ON" side of mirror switch; switch L.E.D. should illuminate immediately and mirror glass will be warm to the touch within two minutes. Return start key "OFF", confirm that L.E.D. is extinguished. Depress "OFF" side of mirror switch.

G. DOOR TRIM PANEL INSTALLATION

Reverse procedure in **STEP A** for driver and passenger doors. Confirm a complete adhesive seal when replacing waterproof film.

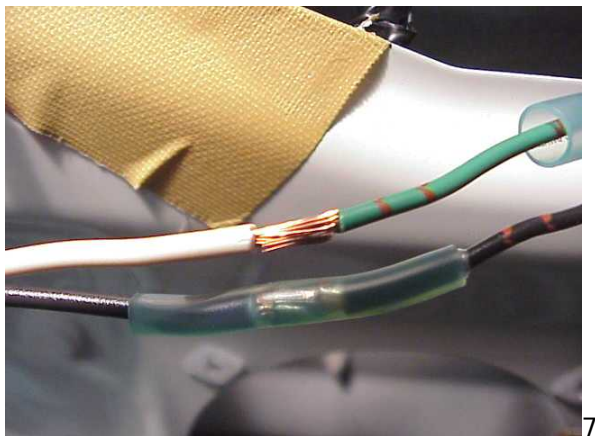
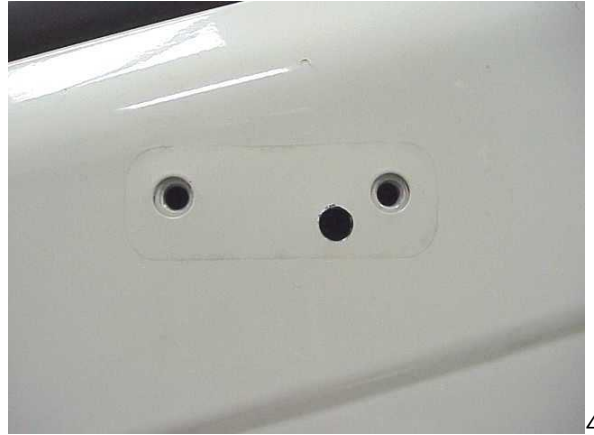
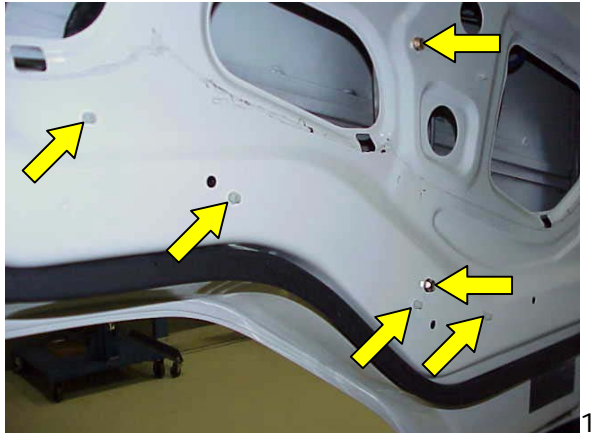

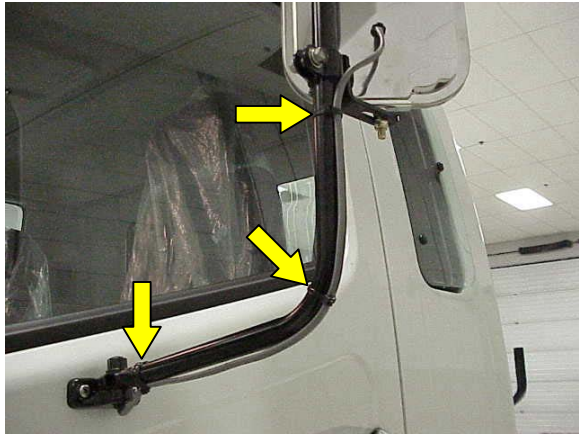

9

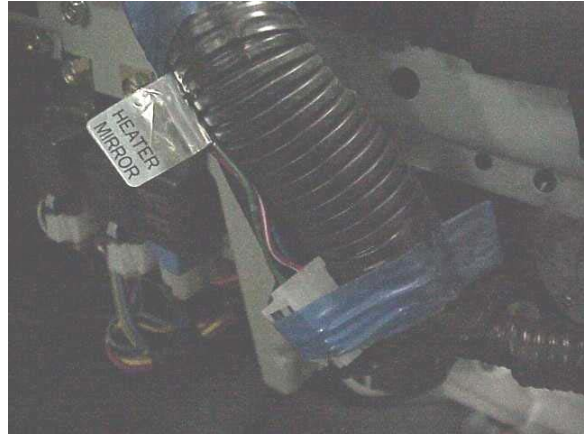

10

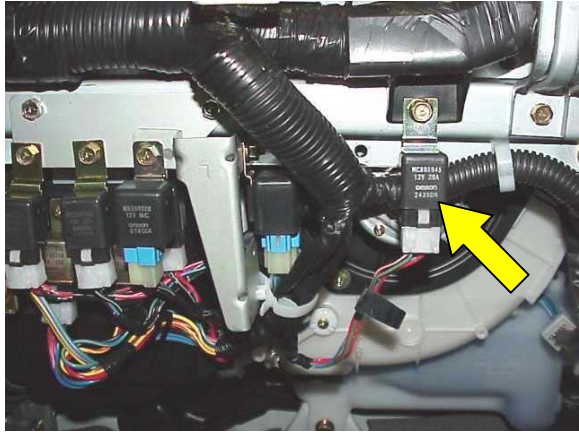

11



12



13

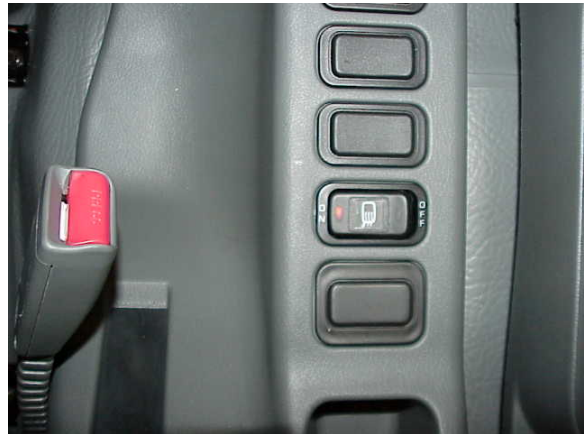

14

INSTALLATION TEMPLATES

DRIVER SIDE

TOP

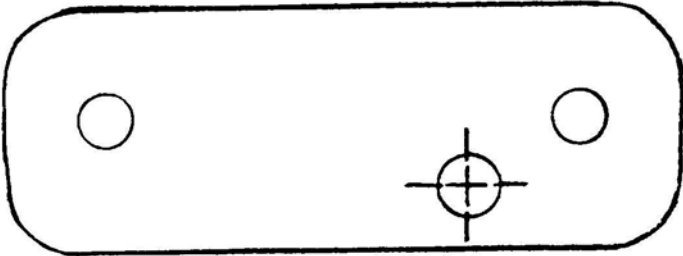

BOTTOM

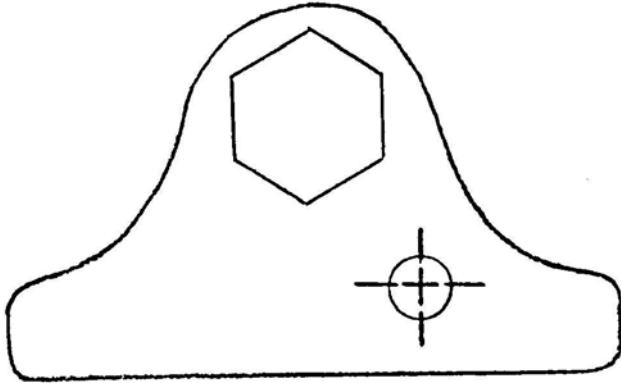

PASSENGER SIDE

TOP

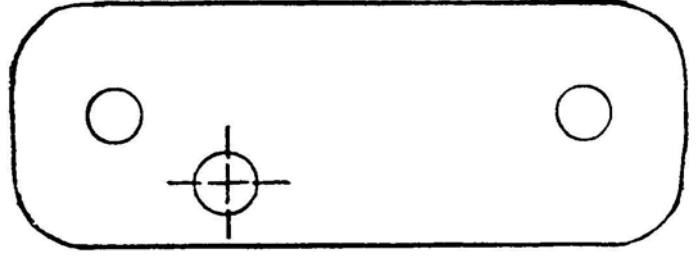

BOTTOM

